

print

Content Furniture brochure

Content Furniture needed a brochure to communicate its unique design and commitment to sustainable materials and design. Concept sketches and detailed 3D renderings were used to show the capabilities of the product. A photograph of a wheat field on the inside cover hints to the availability of particle board made from wheat waste material. The brochure was printed with soy-based inks and on paper with high recycled content.

content.furniture
sustainability at work



A new offering for those exploring **casegoods** furniture in general, as well as those specifically targeting sustainability."

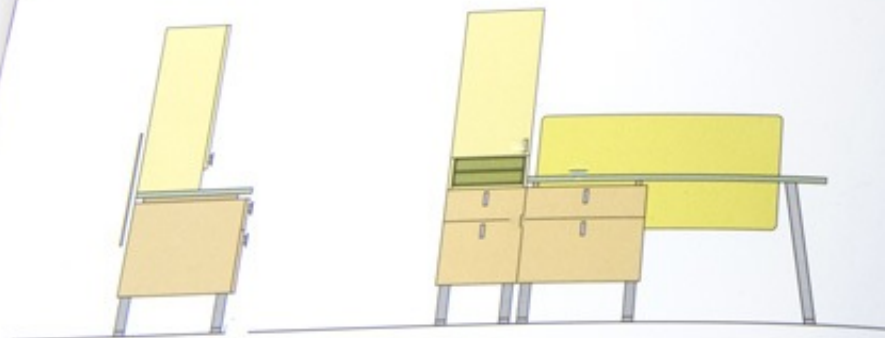

Powder-coated steel legs



Tackable upper cabinet corkboard surface

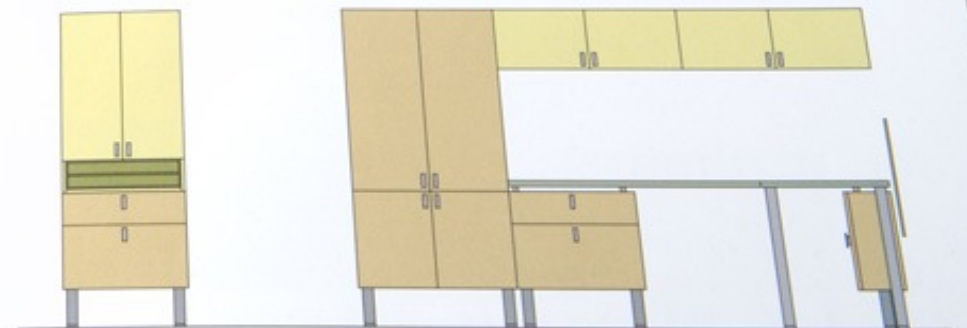



Tod Babick
Principal, Flow



Gary Petertyl
Practice Consultant, Flow



Dennis Kellermeier
Director of Marketing, StelterPartners

Content started with a single question. "Instead of furniture with sustainable options, how about a line of furniture designed right from the start around sustainable materials?"

Beginning with the flexibility of the PartnerStudio platform, we developed an aesthetic and statement of line that is keyed to today's workplace, combined

with a materials strategy based on sustainability. What's emerged is an exceptionally smart furniture solution for our world and for the businesses in it. Content furniture accommodates a wide range of workplace needs with a manageable set of simple components. And it does so with a form that's at once architectural, yet very personal in scale.

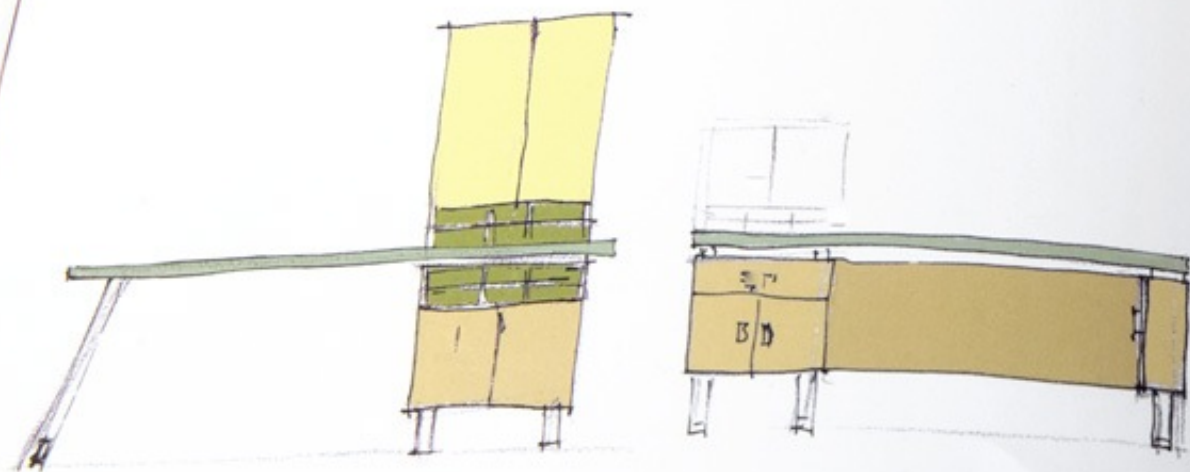

"If you've ever wondered what's in your food, water, or clothing, **this product's for you.**"

—Tod Babick



Much of the warmth and personality of Content furniture comes from the natural aesthetic of sustainable materials such as linoleum, sunflower board, and wood. Content purposefully highlights the character of these materials. For example, to simplify the workspaces, edge banding is eliminated, revealing the beauty of the birch plywood substrate.

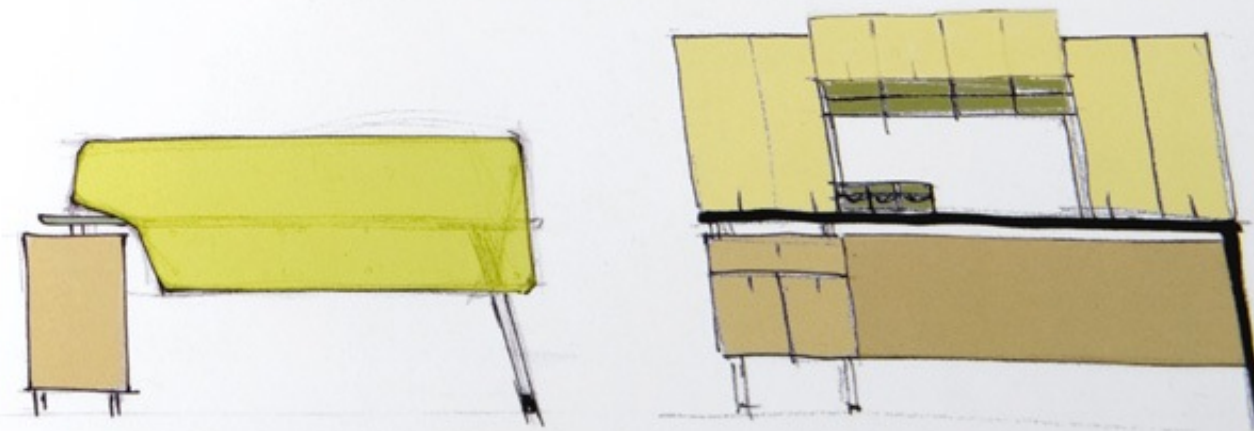



"A new offering for those exploring **casegoods** furniture in general, as well as those specifically targeting sustainability."

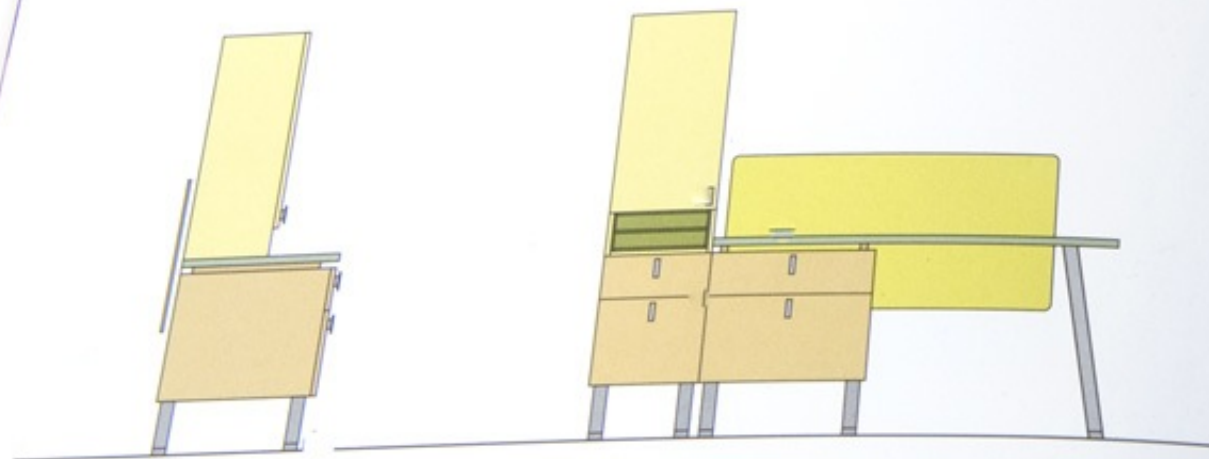

Powder-coated steel legs



Tackable upper cabinet corkboard surface

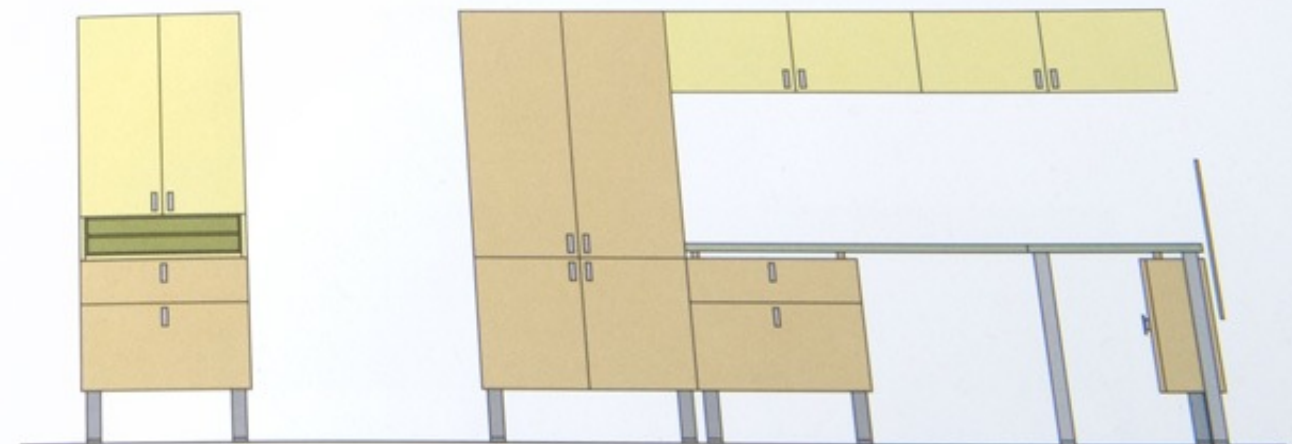

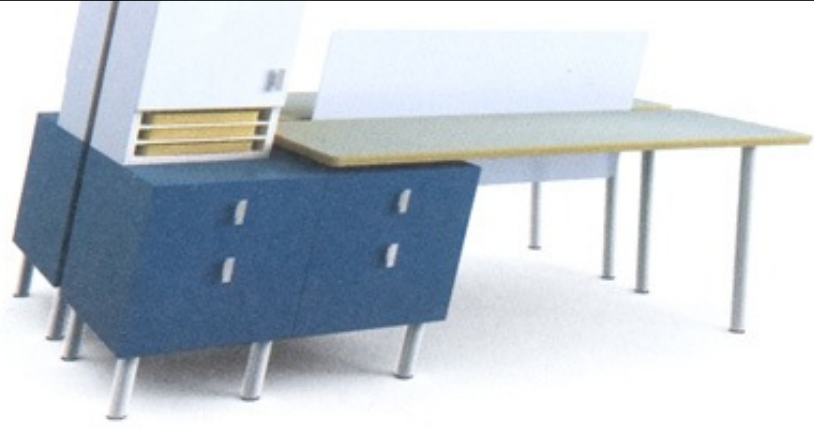

"A new offering for those exploring **casegoods furniture** in general, as well as those specifically targeting sustainability."



Powder-coated steel legs



Tackable upper cabinet
corkboard surface

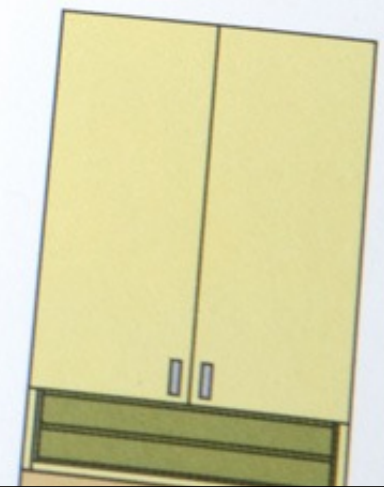
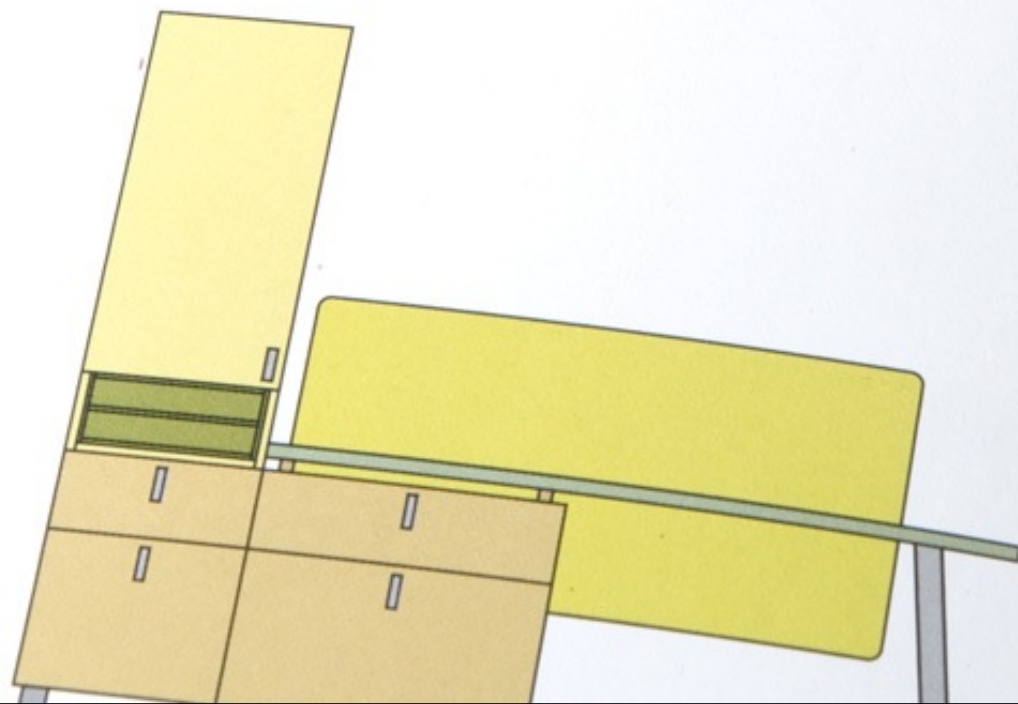
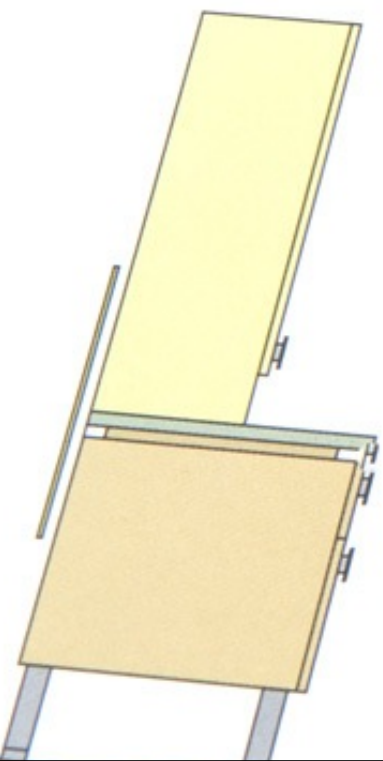

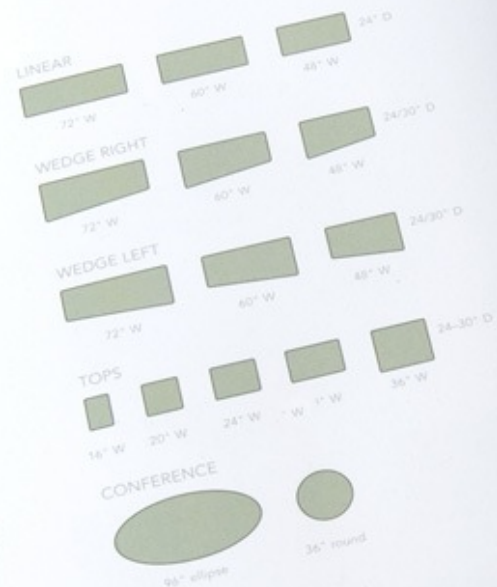
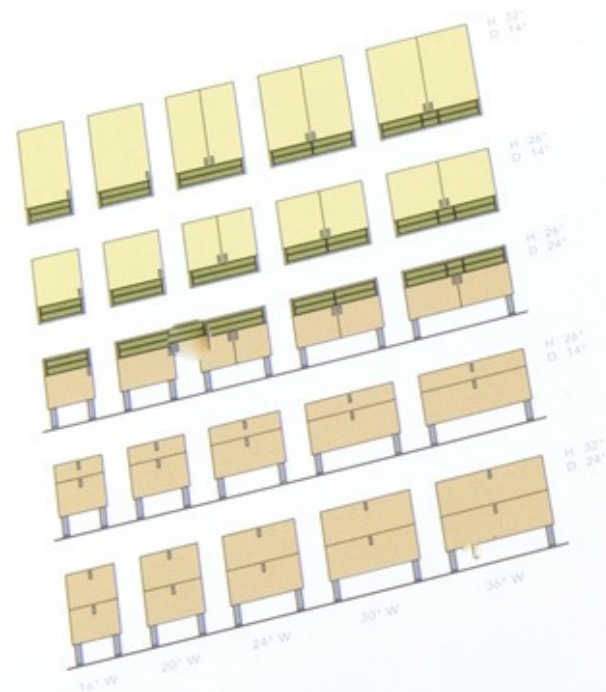

"This collection immediately embraces sustainability by distilling the **product offering** to what's fundamentally necessary."

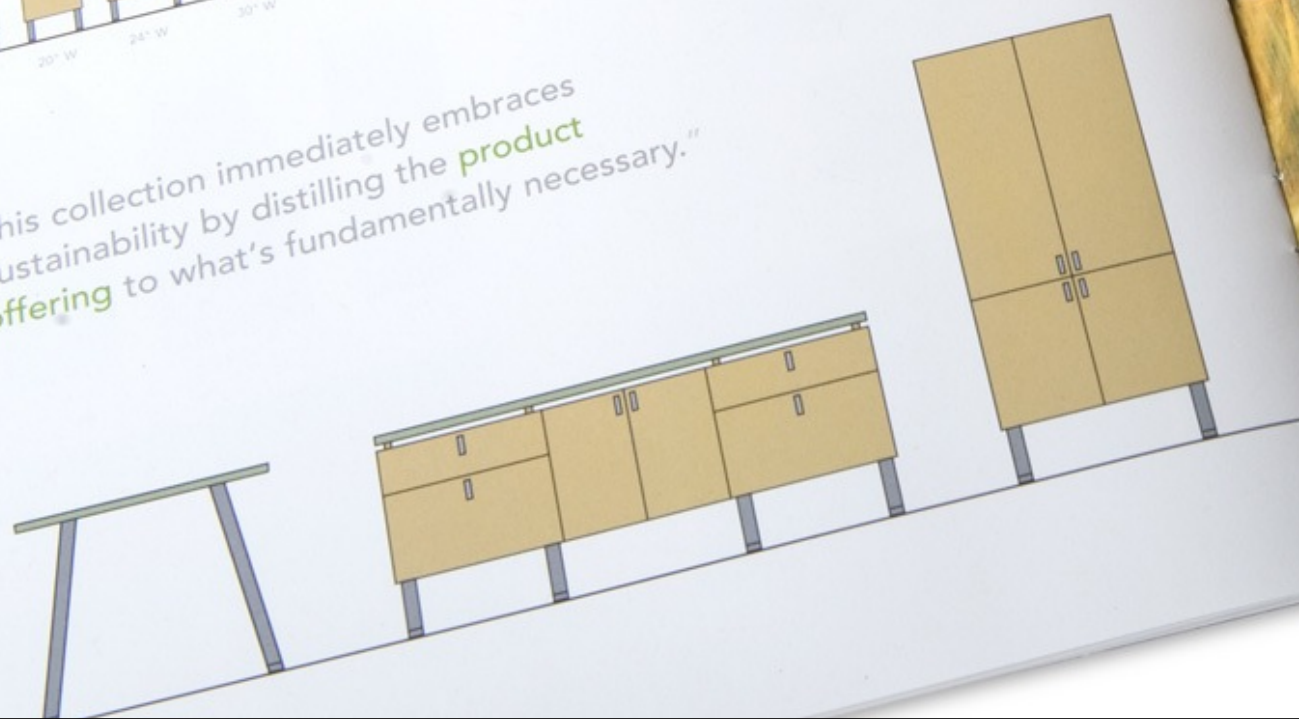

Flagstar Bancorp 2011 annual report

The goal was to design a new annual report format to align with the new brand guidelines and present financial information in an interesting way. Indesign paragraph and character styles were created for this piece which then became the standard for all future print materials for Flagstar Bank.

two thousand eleven



Flagstar
Bancorp

► Profile

#1

Flagstar is the largest bank headquartered in Michigan and the largest publicly held savings bank headquartered in the Midwest.

3,136

3,136 total employees
2,888 Michigan
54 New England

9

Flagstar ranks ninth nationally in total mortgage volume, originating and purchasing loans in all 50 states through a network of brokers and correspondents, as well as 27 retail home loan centers in 13 states.

113

Flagstar operates 113 bank branches in Michigan and a total of four commercial banking offices in Massachusetts, Connecticut, and Rhode Island.

\$13.6

Flagstar had total assets of \$13.6 billion as of December 31, 2011.

7

Seventh in market share in Michigan with 4.4 percent of total deposits

15

Flagstar ranks among the top 15 largest savings banks in the country.

Flagstar Bancorp (NYSE: FBC) is the holding company for Flagstar Bank, a federally chartered stock savings bank. Today Flagstar is a diversified, full-service banking company, offering a wide range of products and services for consumers and businesses of any size.

*See footnote on page 2.

MICHIGAN BRANCH NETWORK



EAST COAST COMMERCIAL BANKING OFFICES



• **Commercial Banking Offices**
4 commercial banking offices in 3 states including Boston, MA (2); Hartford, CT; and Providence, RI

• **Home Lending Offices**
27 home loan centers in 13 states: 14 in MI; also in AL, AZ, CA, CT, FL, GA (2), IL, KY, MA, NJ, OR, and WV

• **Wholesale Offices**
9 wholesale offices in 8 states: CA (2), WA, FL, GA, IL, TX, MD, MA

• **Branch Offices**
113 branches in Michigan

► Leadership



1 Laura Anger 2 Paul Borja 3 Alessandro DiNello 4 Barbara Fischer 5 Kirstin Hammond
6 Steven Issa 7 Matthew Kerin 8 Daniel Landers 9 Michael Maher 10 Todd McGowan
11 Salvatore Rinaldi 12 Marni Scott 13 Marshall Sora 14 Michael Tierney

flagstar.com

Flagstar Bancorp Directors

Joseph P. Campanelli
Chairman of the Board
President and Chief Executive Officer
Governance and Risk Committee

Walter N. Carter
Managing Principal, Gateway Asset
Management Company
Governance and Risk Committee

Gregory Eng
Partner, MP Thrift Investments, L.P.
Compensation Committee
Governance and Risk Committee
Nominating Committee

Jay J. Hansen
President and Co-founder,
O2 Investment Partners, LLC
Chair, Audit Committee

David J. Matlin
Chief Executive Officer,
MP Thrift Investments, L.P.
Chair, Compensation Committee
Chair, Nominating Committee

James A. Ovenden
Chief Financial Officer,
Advance America
Cash Advance Centers, Inc.
Audit Committee

Mark R. Patterson
Chairman,
MP Thrift Investments, L.P.

Michael J. Shonka
Managing Partner,
MJS Advisors, LLC
Audit Committee
Compensation Committee

David L. Treadwell
Consultant, Tennenbaum
Capital Advisors, LLC
Lead Director
Chair, Governance and
Risk Committee

Flagstar Bank Management Team

Joseph P. Campanelli, Chairman, President and Chief Executive Officer
Salvatore J. Rinaldi, Executive Vice President, Chief of Staff
Paul D. Borja, Executive Vice President, Chief Financial Officer and Interim General Counsel
Laura C. Anger, Executive Vice President, Human Resources
Alessandro P. DiNello, Executive Vice President, Personal Financial Services
Barbara J. Fischer, Executive Vice President, Director, Bank Operations
Kirstin A. Hammond, Executive Vice President, Chief Investment Officer
Steven J. Issa, Executive Vice President, Managing Director, Commercial Banking Group
Matthew A. Kerin, Executive Vice President, Chief Credit Officer
Daniel J. Landers, Executive Vice President, Managing Director, Mortgage Banking and Warehouse Lending
Michael R. Maher, Executive Vice President, Director, Mortgage Operations and Servicing
Todd M. McGowan, Executive Vice President, Chief Risk Officer
Marni E. Scott, Executive Vice President, Director, Corporate Services
Marshall P. Sora, Executive Vice President, Managing Director, Personal Financial Services
Michael J. Tierney, Executive Vice President, Managing Director, Personal Financial Services

print advertising



Thanks for letting us prove that local matters.

City to suburb, Flagstar Bank is Michigan-based, Michigan-focused. To us, that means more than just location. It's about building long-term, local relationships—having a heart for the communities we serve.

Visit any of these Lansing-area Flagstar branches:

- | | |
|---|---|
| • 1400 E. Lake Lansing Rd.
East Lansing
(517) 336-4200 | • 3225 Towne Center Blvd.
Lansing
(517) 487-1138 |
| • 5610 W. Saginaw Hwy.
Lansing
(517) 327-2265 | • 1754 Central Park Dr. Ste. J
Okemos
(517) 381-2265 |
| • 7016 S. Cedar St.
Lansing
(517) 699-4040 | |

Personal • Mortgage • Business • Commercial

Talk to us today.
flagstar.com
Like us on 



 Equal Housing Lender

Member FDIC



Local matters.
But, you already knew that.

We like this state. No, we love this state. It's who we are. It's what drives us.

We also like proving that a bank from right here is better for your business.
Not always an easy task. There isn't a mold, only a model—work harder.

Because local matters today and tomorrow. Thanks for letting us prove it.

Personal • Mortgage • **Business** • Commercial

Partner with us today.

(888) 324-4100

flagstar.com/business

Like us on 

 EQUAL HOUSING LENDER Member FDIC

Flagstar[®]
 **Bank**



Hail to the convenience.

Introducing University of Michigan checking accounts from Flagstar Bank.

Open a new University of Michigan checking account — we have three to choose from. While you're at it, select which type of card you want to show the world.

Apply today.
(800) 642-0039
flagstar.com/umich
Member FDIC

Flagstar[®] **Bank** **M**
An Official Partner of Michigan Athletics

Flagstar Bank Detroit Grand Prix invitation

Your Guide To Racing Excitement

2012 Chevrolet Detroit Belle Isle Grand Prix

Flagstar
Bank



Get pumped up!
You're our special guest

Look in the enclosed envelope for your Chalet pass
to the 2012 Chevrolet Detroit Belle Isle Grand Prix.



Flagstar
Bank

Equal Housing Lender Member FDIC



Your ticket to racing
excitement is inside.

Flagstar
Bank

LearningWorks specification guide

The LearningWorks specification guide included four product guides and one finishes guide enclosed in a three-ring binder. The product guides were printed in two-colors to lower printing costs and make filling out the product number easier. To reduce customer service calls, each product guide had a section informing the reader how to build a product number and place an order.



LEARNINGWORKS

PERFORMANCE LAMINATES



ACTIVITY TABLES

Horse Shoe

Low Pressure Laminate, T-Mold, adjustable leg

DIMENSIONS

W	D	H
66	60	23-29

PRODUCT NUMBER

BASE NUMBER

IWTAAT666029LTA

LIST PRICE

\$313

Horseshoe

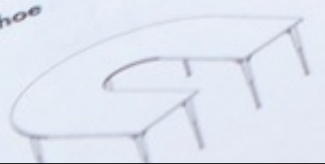

W	D	H
66	60	23-29

BASE NUMBER

IWTAAT666029HTA

LIST PRICE

\$328

POLYPROPYLENE | soft plastic



Hunter 6HN

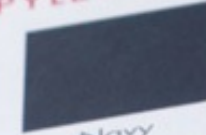

Navy 6NV

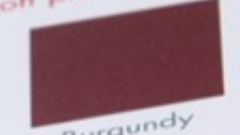

Burgundy 6BU



Grey 6GY



Black 6BK

hard plastic



Mahogany 5MH



Walnut 5WN



Red 5RD



Grey 5GY

COLORS AND FINISHES



Colors and Finishes

TABLES COLLECTION

Classroom Furniture

Tables Collection

CLASSROOM FURNITURE

SCHOOLWORKS COLLECTION

SchoolWorks Collection

MEDIA CENTERS

Media Centers

Logo design

1. Royal Park Hotel is an upscale hotel known for its natural setting.
2. International Bancard is a credit card and merchant services company.
3. Tour Connection is a travel specialist for musicians and entertainers.
4. Original Poetry is a social network for fans of poetry.
5. Pick of the Litter is a logo concept to bring awareness to the benefits of pet adoption.



Royal Park Hotel

INTERNATIONAL





TOUR CONNECTION

The entertainment industry's tour guide.



originalpoetry

write. learn. share.



PICK OF THE LITTER

Nuspire pocket folder and sales sheets

Nuspire needed a customizable way to show their IT capabilities to prospects. After being presented with an initial concept from a senior designer, I began to work out the technical setup of the pocket folder's die-cut to allow text from the slip sheets to show through when inserted into the pocket. A series of information graphics were then designed to help Nuspire communicate how their services work.



nuspire
networks

your network. our responsibility.

Technology is ubiquitous.

Technology is everywhere, critical to move information in every business and every human endeavor. And with it, comes challenge and responsibility.

Fortunately, Nuspire Networks is there for you; a global reach with a local reaction.

Nuspire: your network. our responsibility.

Nuspire: your network. our responsibility

www.nuspire.com

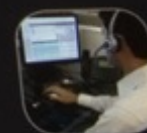

Nuspire: your network. our responsibility.

The migration of business technology to wireless and the public internet drives demand for solution design and deployment. All the while, the continuous onslaught of new cyber attacks, coupled with the increased requirements for compliance with regulations, has made security an ever more expensive drain on resources for all organizations — especially those with multiple locations spread out over large areas.

Nuspire is a state-of-the-science managed network security service provider with more than a decade of industry experience, providing services for some of the largest and most distinctive companies in the world. Nuspire has moved beyond simple firewall maintenance and IDS monitoring to take responsibility for customer networks by using powerful custom-built management and monitoring tools, intrusion prevention systems, in-line anti-virus and anti-spyware tools, URL content filtering, and content aware firewalls. These solutions can be delivered "in the cloud" or enforced with customer premise equipment.

Nuspire provides a comprehensive suite of services focused to meet the needs of organizations with a geographically diverse footprint:

- Network Management & Security Services: Network I Gateway I SaaS I Wireless I Desktop
- Technical Assistance Center (TAC)
- State-of-the-art Network Operations Center (NOC)
- Internet Transport Services
- Global On-site Installation, Integration, Break-Fix & Warranty
- Executive Consulting Services I Application & Systems Development I Technical Consulting

Nuspire Networks will work for you and with you, shoulder-to-shoulder to develop a comprehensive solution, ensuring optimal network performance, security and data asset management, enabling you to focus on your core business.

Security as a service has never made more sense.



nuspire
networks



trax™: Management Monitoring & Resolutions Systems Portal

Businesses are growing more and more dependent on having a fully operational network. Downtime causes a significant impact on business operations. Giving up control of this operation to a 3rd party can be a concern. This is why Nuspire takes a unique, transparent approach to taking control of such an important aspect of any business.

Letting go of the reins (so to speak) doesn't have to mean losing control. Nuspire's custom web-based portal, trax™, has been specifically designed with this philosophy. trax™ is a main component of the Nuspire service offerings. Full access to this web-based tool gives Nuspire customers complete real-time visibility into the operations of their network.

trax™ built and tested in the operations of some of the world's largest companies with the most complicated and challenging network topologies, is continuously evolving. trax™ is a unique, all inclusive portal that empowers customers to visualize rendered services.



Some of the information available at our customer's fingertips includes the following:

• Provides 24/7/365 status of all network devices under our management.

• Allows customers to view and verify the issue is being handled.

• Shows the issue, what the latest status is, the contractor, ISP representative, or even the customer's own representative.

• If the issue is small or involves thousands of devices, real-time reports can be generated and emailed to the customer.

• Provides information about hundreds or thousands of devices under management.

• Team: trax™ has been designed around the needs of network survey data, configuration, and the customer's remote sites is readily available.

• Reporting tools

• Customizable online reporting

• Solution is GLBA, HIPAA, & Sarbanes Oxley compliant.

• Reduces exposure to threats by detecting and preventing intrusions, including DoS attacks.

• Automatically downloads the latest virus and attack database and can accept instant "push" updates from our network.

• Customizable online reporting

• Customizable online reporting

• Customizable online reporting

• Customizable online reporting

• Customizable online reporting

• Customizable online reporting

• Customizable online reporting

• Customizable online reporting

• Customizable online reporting

• Customizable online reporting

• Customizable online reporting

• Customizable online reporting

• Customizable online reporting

• Customizable online reporting

• Customizable online reporting

• Customizable online reporting

• Customizable online reporting

• Customizable online reporting

• Customizable online reporting

• Customizable online reporting

• Customizable online reporting

• Customizable online reporting

• Customizable online reporting

• Customizable online reporting

• Customizable online reporting

• Customizable online reporting

• Customizable online reporting

• Customizable online reporting

• Customizable online reporting

• Customizable online reporting

• Customizable online reporting

• Customizable online reporting

• Customizable online reporting

• Customizable online reporting

• Customizable online reporting

• Customizable online reporting

• Customizable online reporting

• Customizable online reporting

• Customizable online reporting

• Customizable online reporting

• Customizable online reporting

• Customizable online reporting

• Customizable online reporting

• Customizable online reporting

• Customizable online reporting

• Customizable online reporting

• Customizable online reporting

• Customizable online reporting

• Customizable online reporting

• Customizable online reporting

• Customizable online reporting

• Customizable online reporting

• Customizable online reporting

• Customizable online reporting

Gateway

The NuSecure Gateway security system provides a fully integrated and complete solution to detect and eliminate a wide spectrum of attacks and malicious activity including blended threats, intrusion attempts, viruses, trojans, worms, spyware, grayware, adware and denial-of-service. These security services are designed to provide IT administrators with options for a solid, comprehensive security solution.

- Provides complete real-time network protection through a combination of network-based anti-virus, web and email content filtering, firewall, VPN, dynamic intrusion detection and prevention, traffic shaping and anti-spam.
- Eliminates viruses and worms from email, file transfer, and real-time (Web) traffic without degrading network performance.
- Capability for redundant, load-balanced links to multiple ISPs.
- Integrated ports switch provide enhanced fan-out.

- Reduces exposure to threats by detecting and preventing intrusions, including DoS attacks.
- Automatically downloads the latest virus and attack database and can accept instant "push" updates from our network.
- Solution is GLBA, HIPAA, & Sarbanes Oxley compliant.
- Customizable online reporting



nuspire
networks

Technical Assistance & Network Operations Center (NOC/TAC)

Nuspire is truly a "Managed Network Services Provider", managing technologies, applications, and manufacturers as tools to protect your business.

One such tool is the Nuspire Network Operations/Technical Assistance Center (NOC/TAC). The staff is certified in various technologies and holds numerous industry certifications such as CCNA, CCNP, and CCSP. Nuspire also has a stringent screening process for hiring the best talent, ensuring continuous performance monitoring, and you can easily see the results. The staff is monitored by some of the most qualified and motivated staff equates to an end product that provides complete value. Nuspire assumes accountability and delivers a world-class service.

NOC/TAC Facets:

- Flexible IP-based telephony system that can be customized for your needs to support warm transfers, call transfers, direct dials, custom pick trees, and more.
- Up-to-date knowledge base for quick resolution of common issues.
- Customized ticketing system that supports online web-based access, automated ticket generation based on predetermined alerts, integration capabilities for seamless integration with customers and partners systems, and ticketing dashboard for quick reference to verify SLAs are met.



nuspire
networks

- Powerful reporting engine that captures data from the phone system logs, ticket system, monitoring tools, and event management tools.
- Real-time, heads-up monitoring dashboards for quick reference and real-time view of the health of customer's networks and systems.
- Drill-down access to all managed devices.
- Uptime and downtime status reporting.
- Trend analysis for proactive monitoring.
- Early fault detection.
- Node failure recovery.
- Asset management.

your network. our responsibility.

your network. our responsibility.

Nuspire offerings in this area include:

Vulnerability Assessment/Penetration Testing – Using anything from available tools that "script kiddies" use, to sophisticated custom tools, a "hacker" might use to scan for vulnerabilities, a present time snapshot of your network and your security posture can be gleaned.

Risk Management – Once an adequate vulnerability assessment is achieved, an enterprise will have a clearer picture on what resources are at risk and what the damage would be if those resources were compromised. Nuspire certified professional engineers help customers understand where their efforts and budget should be focused.



nuspire
networks

your network. our responsibility.

Technical Assistance & Netw

Nuspire is truly a "Managed Network Services Provider," not just a provider of technologies, applications, and manufacturers as tools to protect your network.

One such tool is the Nuspire Network Operations/Technical Assistance (NOC/TAC) is in operation 24/7/365. The staff is certified in various technologies to reputable industry certifications such as CCNA, CCNP, and CCIE. Nuspire also has a stringent screening process for hiring the best talent. Continuous performance monitoring, and you can easily see the results. The staff equates to an end product that provides complete visibility into your network. Nuspire assumes accountability and delivers a managed network solution.

NOC/TAC Facets:

- Flexible IP-based telephony system that can be customized for your needs to support warm transfers, cold transfers, direct dials, custom pick trees, and more.

- Complete real-time network protection through a combination of network-based anti-virus, web and email content filtering, firewall, VPN, dynamic intrusion detection and prevention, traffic shaping and anti-spam.
- Eliminates viruses and worms from email, file transfer, and real-time (Web) traffic without degrading network performance.
- Capability for redundant, load-balanced links to multiple ISPs.
- Integrated ports switch provide enhanced fan-out.

- Reduces exposure to threats by detecting and preventing intrusions, including DoS and DDoS attacks.
- Automatically downloads the latest virus and attack database and can accept instant "push" updates from our network.
- Solution is GLBA, HIPPA, & Sarbanes Oxley compliant.
- Customizable online reporting

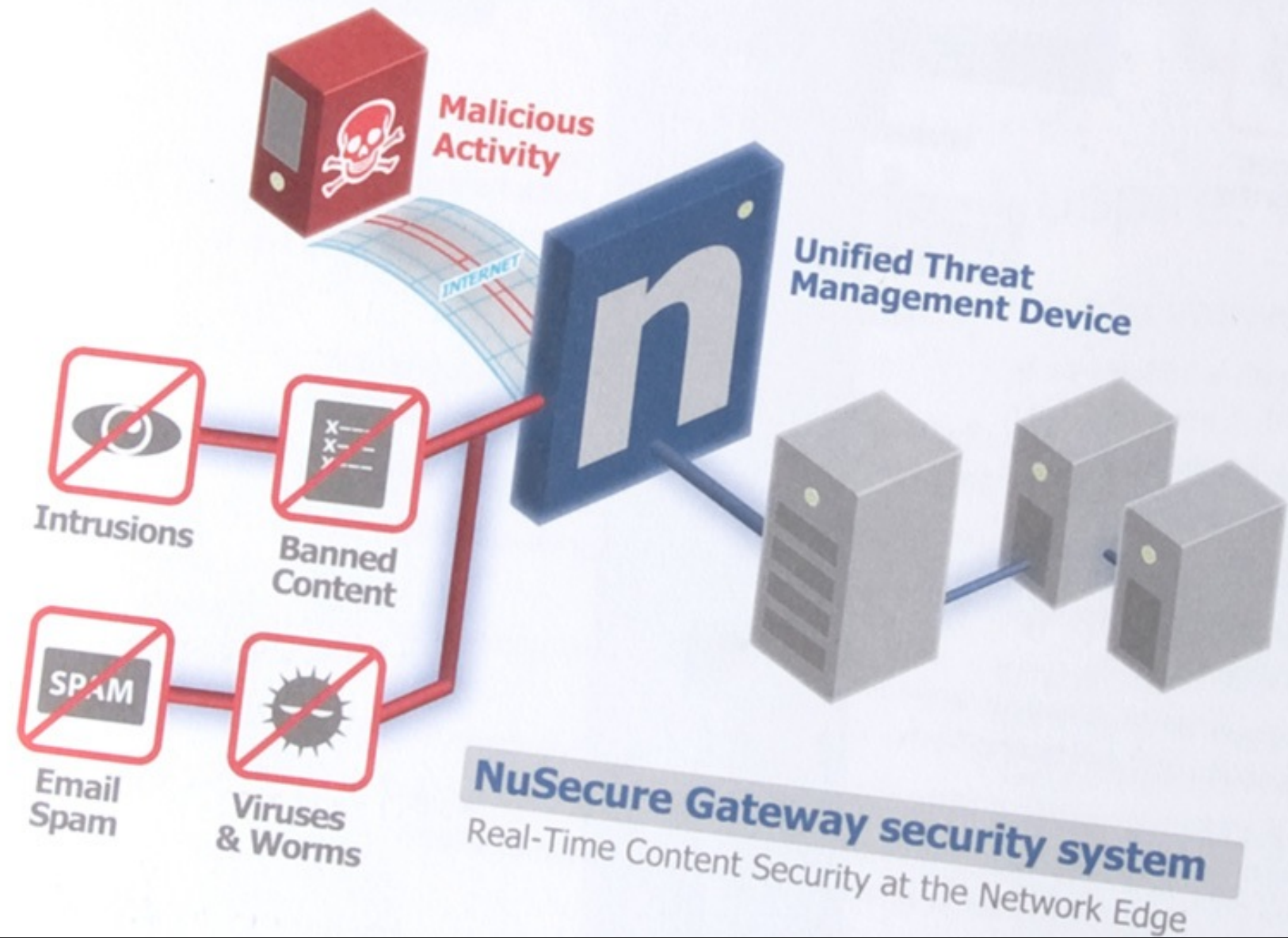

information graphics



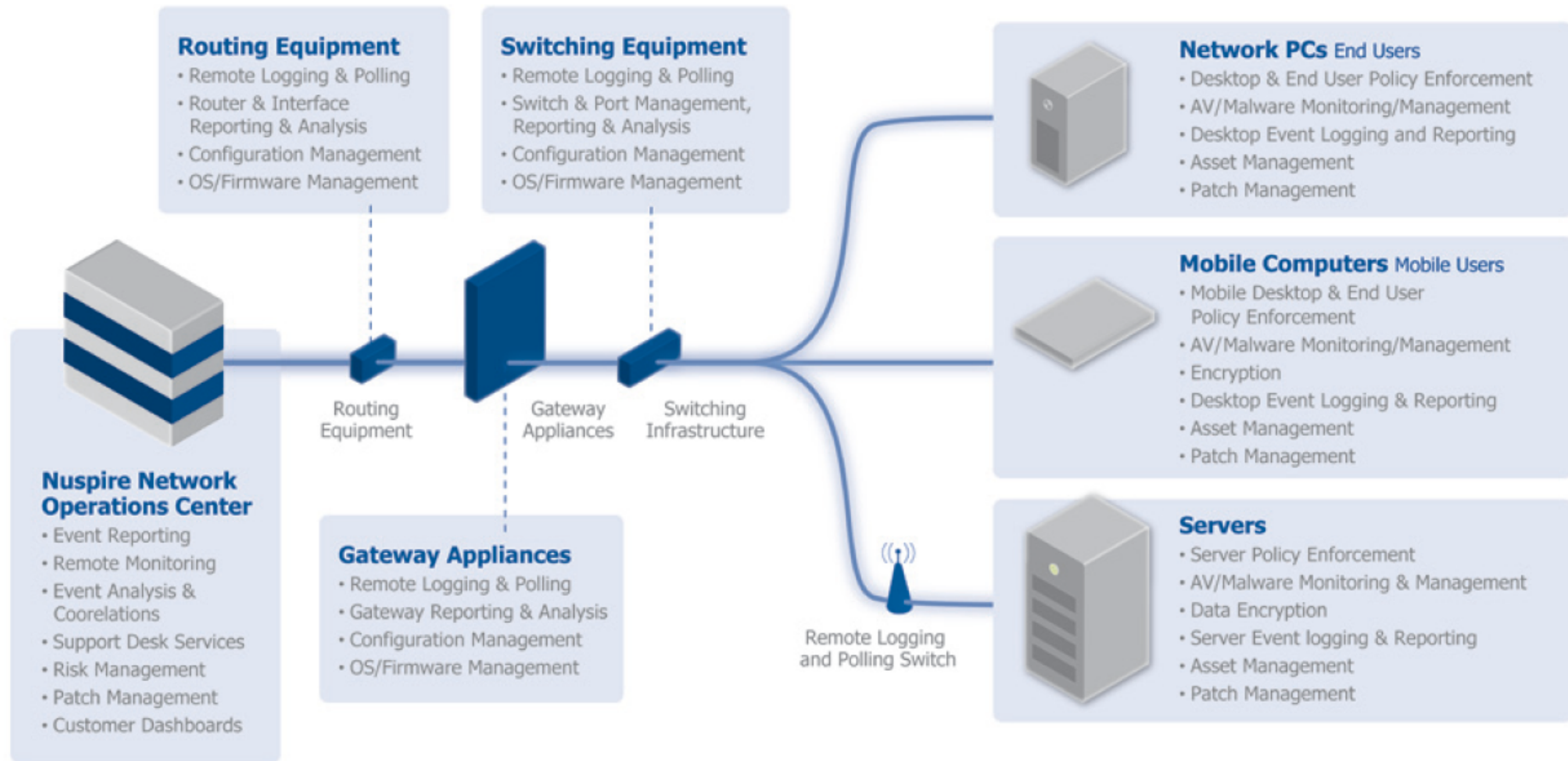

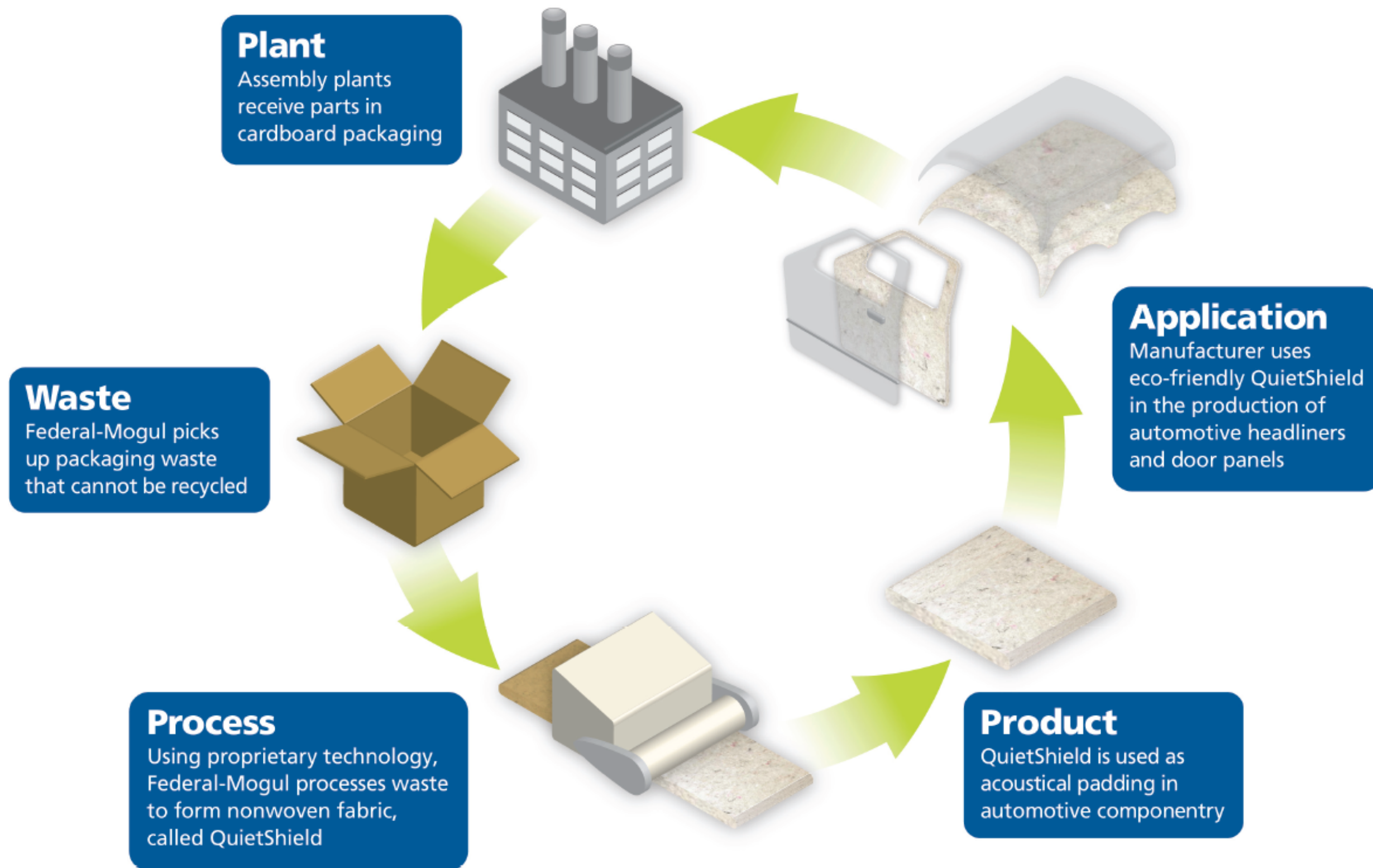

Flagstar Bank SimplyYou
point of sale placematt

SimplyYou

Enjoy these perks on all Flagstar personal checking accounts

- Online Banking and Bill Pay
- Free Flagstar Visa® debit card or Flagstar ATM card
- Free access to a network of more than 50,000 ATMs worldwide
- Free Mobile Banking app¹
- 24-hour Telephone Banking at (888) 248-6423
- Unlimited check writing (no per-check fee)
- Free FinanceWorks™—a suite of online financial tools
- Free annual investment review
- Free annual mortgage analysis
- Purchase Rewards when you use your Flagstar Visa® debit card — earn personalized cash-back offers²
- Optional Automatic Savings Plan — transfer money directly from your checking account into savings

Real keepers on Flagstar personal savings and money market accounts³

- Online Banking and Mobile Banking¹
- Free access to a network of more than 50,000 ATMs worldwide
- No minimum to open⁴
- Free 24-hour Telephone Banking at (888) 248-6423
- Optional Automatic Savings Plan — transfer money directly from your checking account into savings

Preferred CD rates⁵

- Get a higher CD rate by maintaining \$5,000 or more in combined personal checking, savings, and money market accounts

flagstar.com/whyflagstar

¹Not all devices may be supported. ²HELOC and IOLTA accounts are not eligible. ³In compliance with federal law, the number of savings or money market account withdrawals are limited to 6 per month, unless the withdrawals are made at a branch, an ATM, or by mail. ⁴Minimum \$1 deposit to open a savings or money market account online. Minimum \$50 deposit to open an IRA savings account at any Flagstar branch. ⁵Excludes promotional rates. ⁶Interest rates are tiered to a maximum amount. Visit a branch or flagstar.com to view our interest rates. ⁷Based on Average Daily Balance. We reserve the right to change account benefits at any time. ⁸Subject to loan approval. Excludes mortgages. ⁹Once per year, receive a free box of Flagstar custom checks or 50% off any other check style.

FinanceWorks is a trademark of Intuit, Inc.

 EQUAL HOUSING LENDER Member FDIC #5407V10/04/12



Checking

SimplyChecking

Keep things simple.

- No monthly service fee
- No minimum balance required
- View your statement online at no cost; paper statements are available for a \$2 monthly fee
- Minimum \$50 deposit to open

SimplyPlus Checking

Build a nest egg.

- The higher the balance you maintain, the higher the interest rate⁶
- \$10 monthly service fee waived with a \$1,000 balance⁷ or a \$5,000 balance⁷ in combined personal checking, savings, money market, and CD accounts
- Flagstar \$2.50 ATM transaction fee waived when you use another bank's ATM (two times per statement cycle)
- 0.25% rate reduction on personal loans and home equity lines of credit (HELOCs)⁸
- Paper statements are available at no charge
- Mistakes happen—Flagstar will refund the fee on one overdraft item per year (upon request)
- Minimum \$50 deposit to open

If you're 50 or over:

- There's no monthly balance required, no monthly service fee, and this account includes free checks⁹

SimplyMax Checking

Go for it all.

- Our highest checking account interest rates⁶
- \$25 monthly service fee waived with a \$5,000 balance⁷ or a \$25,000 balance⁷ in combined personal checking, savings, money market, and CD accounts
- Flagstar \$2.50 ATM transaction fee waived when you use another bank's ATM (unlimited)
- 0.25% rate reduction on personal loans and HELOCs⁸
- Paper statements are available at no charge
- Mistakes happen—Flagstar will refund the fee on one overdraft item per year (upon request)
- We'll refund up to \$20 per statement cycle in ATM fees charged by other banks (upon request)
- We'll waive the \$75 annual HELOC fee if you keep a funded balance in your HELOC of \$10,000 or more
- Free box of Flagstar checks or 50% off any other check style⁹
- Fee-free cashier's checks and money orders
- Free ID Protect Program
- Minimum \$50 deposit to open



Savings & Money Market

SimplySavings

All about flexibility.

- \$3 monthly service fee is waived when paired with a Flagstar checking account or when a \$300 balance⁷ is maintained

SimplyMoneyMarket

Interest and access.

- The higher the balance you maintain, the higher the interest rate⁶
- \$10 monthly service fee is waived when paired with a Flagstar checking account or when a \$5,000 balance⁷ is maintained
- You can write checks from this account (restrictions apply)

SimplyMax Savings

Great earning power.

- The higher the balance you maintain, the higher the interest rate⁶
- \$25 monthly service fee is waived when paired with a Flagstar checking account or when a \$25,000 balance⁷ is maintained



SimplyKids Savings

Teach them the ropes.

- No minimum balance or monthly service fee
- Higher interest rate on the first \$500 deposited
- Can be opened for kids and young adults up to 23 years of age

IRA Savings Account

Grow at your own pace.

- Offers an easy option to deposit to an IRA a little at a time
- An ideal account to deposit your transfer or rollover IRA or 401(k) while you make longer-term investment decisions
- \$5 annual fee covers all accounts under the retirement plan
- Minimum \$50 deposit to open

Flagstar®
Bank

SimplyYou 

SimplyChecking 

SimplyMax Checking  SM

SimplyPlus Checking  SM

University of Michigan Athletics debit cards

Debit cards were produced to support Flagstar Bank's partnership with U-M Athletics. Recognizable and iconic imagery was used to attract existing Michigan fans to open checking accounts. Since the cards were introduced there has been a considerable increase in the amount of new account openings.



Go Blue with every purchase.



Introducing the new University of Michigan Athletics banking accounts and debit cards from Flagstar Bank.

Choose from one of three Michigan-branded debit cards:

- M card
- Big House card
- Winged Helmet card

Whether you're a current student, alum, or a fervent fan, we have what you need:

- Online Banking and Bill Pay
- Free access to a network of more than 50,000 ATMs worldwide
- Free mobile banking app¹
- Designer U-M checks

And of course, you'll show your Michigan pride with every purchase.

HAIL! Checking

Looking to keep things simple? Here's a no-nonsense account that gives you the ability to make purchases, write checks, and access your cash—all with the style of a super fan.

Key account features:

- No monthly service fee
- No minimum balance required
- Free mobile banking app¹
- Online Banking and Bill Pay

AMAZING Savings

We get it. You're a student and looking to save for the future, but may not have a lot right now. That's okay! Amazing Savings² is the account for you. You'll even earn higher interest on your first \$500 deposited.

Key account features:

- No monthly service fee
- No minimum balance required

Flagstar[®] Bank 
An Official Partner of Michigan Athletics



Flagstar[®] Bank 

An Official Partner of Michigan Athletics

Visa U.S.A. Inc. All checking accounts require a \$50 deposit branch for details. ¹Interest rates are tiered to a maximum on Average Daily Balance. Unlike many other banks, we use monthly service fees on all of our deposit accounts. This means no service fee as long as your Average Daily Balance for the entire loan approval. Excludes mortgages. ²Once per year, receive statement cycle refunded upon request.

trade show booth graphics



ELECTRIC
VEHICLE
CHARGING
STATION

40 Miles
ALL ELECTRIC RANGE

FEV

ReEV
RANGE-EXTENDED
ELECTRIC
VEHICLE

DELPHI

PIERBURG
PUMP TECHNOLOGY

UQM

FEV Developed
Range-extended
Electric Vehicle
(ReEV) Concept
with 40+ Miles All-Electric Range



FASTSMARTGREEN
Accelerating innovation into the new reality

FEV
www.fev.com

Solid SCR System



**Full-Sized, Low-NOx
Diesel Pickup Truck**
A Solid Solution to NOx Control

The FEV Solid SCR System is a full-sized, low-NOx diesel pickup truck. It is a solid solution to NOx control, offering a complete system for reducing NOx emissions. The system includes a diesel engine, a turbocharger, and a SCR catalyst. The FEV Solid SCR System is a full-sized, low-NOx diesel pickup truck. It is a solid solution to NOx control, offering a complete system for reducing NOx emissions. The system includes a diesel engine, a turbocharger, and a SCR catalyst.

FASTSMARTGREEN
Accelerating Innovation to the Green

FEV
www.fev.com



THINK ASPHALT
THINK **EZ STREET**®



actual size
cardboard
cut-out



vinyl floor mat
(could be used for wayfinding
by adding arrows or a booth #)



WorkSphere product sheets

WorkSphere needed product sheets for their upcoming furniture exhibit. Since this was a new product line, we needed to collect existing photography from vendors and retouch new photography shot in our warehouse. The sales team requested a way to customize the product sheet package to fit a particular client and provide a place for their business card. To solve this problem, we designed a series of product sheets that could easily be rearranged and customized for a particular client. The sheets were then wrapped with a branded cover with a die-cut to allow a sales person to insert their business card.



DESKING

SEATING



who is worksphere?

WorkSphere

choice
speed
simplicity

You want it. We've got it.

© 2006 Steelcase, Grand Rapids, Michigan. The WorkSphere is a trademark of Steelcase, LLC. Following our commitment to a healthy environment, this folder is printed on paper containing 15% post-consumer recycled fiber.

ACCESSORIES

TABLES

DESKING

SEATING



who is worksphere?

bay™

Design by: Brian Kane and Mark Kapka

This expressive collection of tables from Brian Kane and Mark Kapka thoughtfully balance yet classic design while providing the flexibility and durability needed for today's learning. Legs are mechanically height adjustable with an allen wrench so its easy to adjust, but could move them on their own.



Round top with casters



Trapezoid top



Rectangular top with casters



Kidney top with modesty panel

SPECIFICS

- Stylish height-adjustable powder-coated in s charcoal
- Table height adjustable 22"-30" in 1"
- Standard perforated laminate top with 2mm vinyl edge friendly 2"

SIDE DISHES

Add some accessories to make your table ultra-functional.



See the Techno and Accents pages for more options and info.

AVAILABLE



Custom

sustain™

Design by: WorkSphere Design Team

WorkSphere believes in treating the earth the way we would want to be treated. With respect and care. That means having standard offerings that are good to the earth as well. Sustain tables answer the call. Linoleum, sunflower board, or wheat board tops are all options we can offer. Pair your Sustain table with our aluminum or plywood seating, and you've got a sustainable story to tell.



Stained wheat board top



Sunflower top

BASE OPTIONS



Arch X base



Bay base



Rise height-adjustable base



Rise stationary base

EARTHY LINGO

Linoleum:

All-natural product from Forbo made of reclaimed content, including linseed oil, rosin binders, ground cork, wood flour, mineral fillers and non-toxic pigments. Emits no harmful VOCs or carcinogens and inhibits bacteria growth.

Sunflower Board:

Renewable sunflower seed, an agricultural fiber by-product. Creates a distinctive pattern reminiscent of burl wood.

Wheat Board:

Renewable wheat straw, an agricultural fiber by-product. Offers a rich golden alternative to traditional hardwoods.



Wheat board and sunflower tops

EARTH FRIENDLY TOPS

LINOLEUM



SUNFLOWER BOARD



WHEAT BOARD



Please call your WorkSphere representative for availability and pricing.

AVAILABLE SIZES

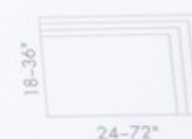

24-72"



24-60" round

Custom shapes and sizes available.

WorkSphere™
a StelterPartners company

616.451.7800

© 2006 WorkSphere is a trademark of StelterPartners®, LLC.
WSTB

WorkSphere™
a StelterPartners company

Cole Wagner Cabinetry brochure

Cole Wagner Cabinetry requested a promotional brochure to showcase their custom hand-crafted cabinetry. The brochure uses design elements of a chisel and woodcarvings to support the photography of completed projects. The hand writing style of the paragraph headings hint to the hand-crafted nature of the work.



Why Choose Us

Cole Wagner Cabinets (CWC) does not simply build your custom project but can and will help through each stage of its process. We are a "one stop" cabinet shop and we have the ability to design, craft, finish, and install not only custom cabinetry but custom furniture as well. All of our cabinets are built in-house at our Rochester Hills facility which gives our clients the opportunity and the flexibility to be involved in each phase of development.

CWC offers a number of custom countertops from a variety of materials and different manufacturers. These options include quartz by Silestone, Cambria, Zodiax, and Technistone; granite, natural stone, Corian, laminate, stainless steel and wood in any species. We also use Richlite, a recycled paper countertop product that is not only environmentally friendly but available in a vast assortment of colors to match any design. We have a selection of cabinet door styles to choose from and custom styles are also available. In addition to new doors, we are able to custom match any existing cabinet doors or pieces of furniture in your home or office.

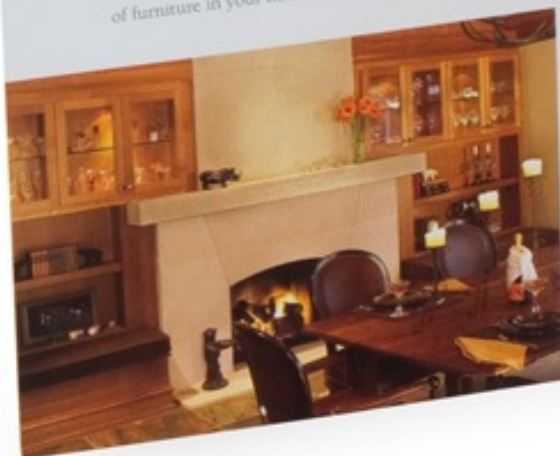

We have our own state-of-the-art finishing booth that allows us to customize the finish on each individual project. These custom finishes include paint matching, staining, distressing, and glazing. If your project requires a more detailed, handcrafted finish we are able to do hand planing and oil rub finishes. Whatever finish you desire, we will work with you to develop the look you seek.



If custom cabinetry is not what you are looking for, you have the option to choose from a line of manufactured cabinets. CWC is also a licensed Merillat® cabinets dealer. We have access to all three of their cabinet lines and they are available in a variety of price levels to fit any budget.

Our services include, but are not limited to the following:

- Custom Cabinetry
- Kitchens
- Libraries & Bookcases
- Wine Cellars
- Garage Cabinets
- Closet Organizers
- Furniture
- Paneled Walls
- Wainscoting
- Millwork & Moldings
- Custom Countertops & Doors



Green Aspect

Not only are our customers important to us but the environment is also a priority to our company. At CWC we are continually incorporating and researching products and resources that are certified green. Recycling is an important part of our daily business routine from office supplies to wood waste from each project. All of our finish waste is recycled into roofing materials and caulks, and the waste from our doors and drawers is reused for animal bedding, landscape mulch and energy for power plants. Our finishes have low VOCs and the plywood we currently use is made with glue that does not contain formaldehyde.



Closing Thoughts

By choosing CWC you will acquire beautiful, high-quality cabinetry and furniture that will last a lifetime. You will have professional design help through the beginning stages and final approval on all aspects of the project before it goes into production. We are committed to serving our clients with professionalism and courtesy no matter what your needs may be. CWC will not only design and build your dream but will be available to assist you if there is ever a need to repair your product.

If you are considering a project and would like to discuss a proposal with CWC please contact our office at (248)832-2406.

We look forward to working with you in the future and hope you will think of us for all your woodworking needs.





Our Story

Cole Wagner Cabinetry is based in the heart of Southeastern Michigan and takes great pride in its Michigan roots. In January of 2005 Templeton Building Company expanded their cabinetry division by acquiring Avon Cabinets, an established company that had been in business for over 34 years. In order to keep the building division and the cabinetry division separate, the decision was made to rename it Cole Wagner Cabinetry. Now operating as CWC, our goal is to create high-quality, custom cabinetry and furniture.

We believe strongly that developing solid, long-lasting relationships with all of our clients is the key to building beautiful products.



2511 Leach Road | Rochester Hills, Michigan 48309 | 248.852.2406 | cwagner@cw-cabinetry.com



Jacob Lett

Web design and digital marketing specialist

jacob@jacoblett.com | (586) 258-8627 | jacoblett.com